

# *Available for Lease – Industrial Park*

## *7900A State Road, Philadelphia, PA*



### **Showroom/Warehouse**

**4,000± Sq. Ft.**  
**State Road Frontage**

**Traffic Count:** 20,000 Cars  
Per Day

**Parking:** Off Street

**Loading:** Off Street Tailgate  
Dock w/8'x8' Door

**Ceiling Height:** 18'

**Heat:** Gas – Ceiling Mounted

**Bathrooms:** One

**Electric:** 100 A – 1 Phase

**Lighting:** Fluorescent

**Floors:** Concrete

**Sprinkler:** Dry System  
Monitored

**Zoning:** I-2 Industrial



**Daniel J. Lasdon**  
**Real Estate**

**700 East Erie Avenue**  
**Philadelphia, PA 19134**  
**215-426-8130**  
[Information@lasdonrealestate.com](mailto:Information@lasdonrealestate.com)

**4,000± SF – Showroom/Warehouse**  
**7900A State Road, Philadelphia, PA**

Not to Scale  
For Advertising Purposes Only

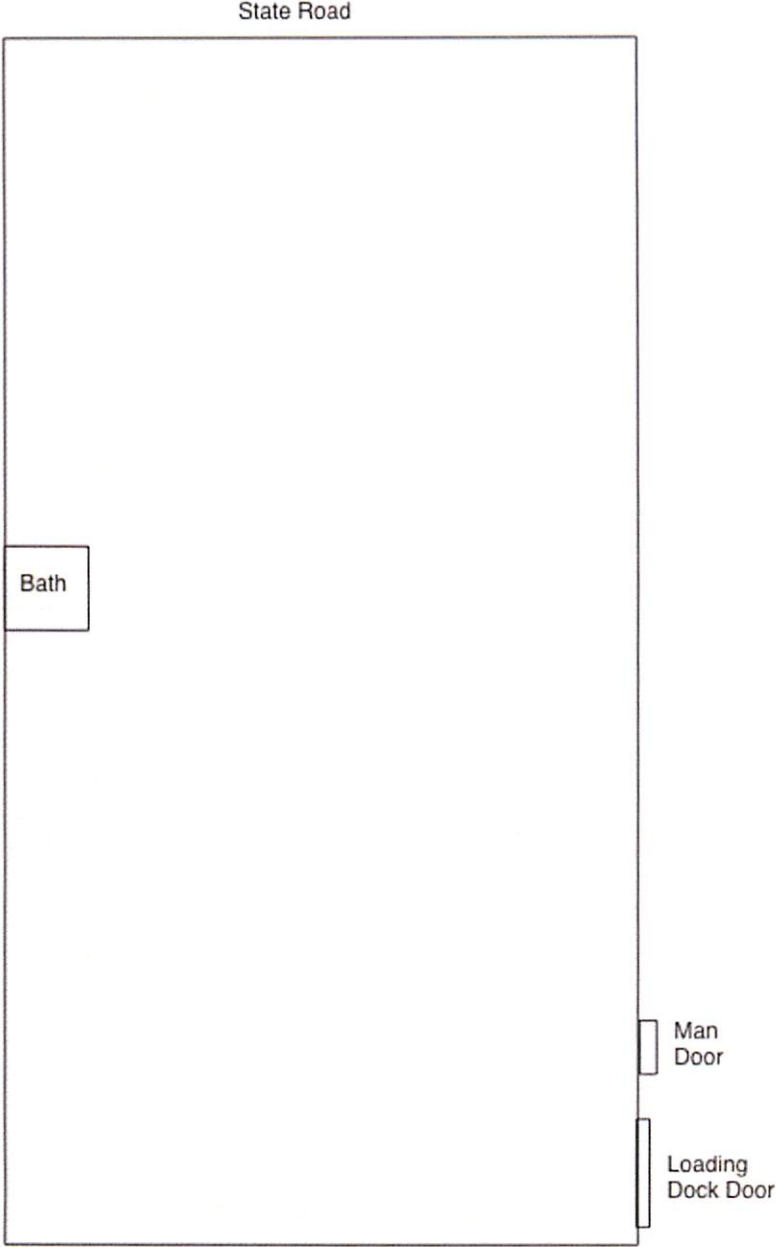

7900A State Road  
4,000 +/- SF